

CITY of ALBUQUERQUE
NINTH COUNCIL

COUNCIL BILL NO. C/S R-14

ENACTMENT NO. 95-1992

SPONSORED BY: Alan B. Armijo

RESOLUTION

ADOPTING AND MAPPING THE UNSER BOULEVARD DESIGN OVERLAY ZONE.

WHEREAS, the Council, the governing body of the City, has the authority to adopt plans for physical development within the planning and platting jurisdiction of the City, as authorized by New Mexico statutes and by the City Charter as allowed under home rule provisions of the New Mexico Constitution; and

WHEREAS, the planned and partially existing arterial street running northward from the Unser/I-40 interchange to the Sandoval County line will be one of the most important streets in Albuquerque, providing access to much currently undeveloped property on the city's west side; and

WHEREAS, Unser Boulevard will offer significant views of the Rio Grande Valley, the Sandia Mountains and the west mesa escarpment and volcanoes; and

WHEREAS, establishing specialized sign controls for the Unser corridor is an important step in protecting the area's unique views and in providing the best possible visual image for those travelling on this new roadway; and

WHEREAS, Unser Boulevard is planned to be a parkway with a very high quality appearance; and

WHEREAS, Unser Boulevard will be a principal entranceway to the Petroglyph National Monument and will run along its boundary; and

WHEREAS, the above circumstances constitute a change in area conditions which justify this overlay zone; and

WHEREAS, the Environmental Planning Commission has recommended a Design Overlay Zone regulating signs within the Sunport Corridor; and

WHEREAS, the Environmental Planning Commission recommendation included revised sign regulations for the Unser Corridor.

Underscored Material - New
[Bracketed Material] - Deletion

1 BE IT RESOLVED BY THE COUNCIL, THE GOVERNING BODY OF THE CITY OF
2 ALBUQUERQUE:

3 That the area shown on the attached Exhibit 1, "Unser Design Overlay Zone
4 Boundary," is zoned with the Design Overlay Zone in addition to the previously mapped
5 zones, and the regulations which apply as a result of this overlay zone are those
6 specified on the attached Exhibit 2, "Unser Boulevard Design Overlay Zone," both of
7 which exhibits are made a part hereof.

8
9
10
11
12
13
14
15
16
17
18
19
20
21
22
23
24
25
26
27
28
29
30
31
32
33

Underscored Material - New
[Bracketed Material] - Deletion

1 PASSED AND ADOPTED THIS 29th DAY OF June, 1992.

2 BY A VOTE OF 8 FOR AND 0 AGAINST.

3 Yes: 8
4 Excused: Gallegos

5 Pauline K. Gubbels
6 Pauline K. Gubbels, President
7 City Council

8
9 APPROVED THIS 9th DAY OF July, 1992.

10
11
12 Louis E. Saavedra
13 Louis E. Saavedra, Mayor
14 City of Albuquerque

15 ATTEST:
16 Paula Green
17 City Clerk

18
19
20
21
22
23
24
25
26
27
28
29
30
31
32
33

Underscored Material - New
[Bracketed Material] - Deletion

UNSER BOULEVARD DESIGN OVERLAY ZONE

The Unser Boulevard Design Overlay Zone is intended to provide specialized sign controls for the area surrounding Unser Boulevard between Interstate 40 and the Sandoval County line. The Overlay Zone regulations apply to all non-residential zones and any residential zones allowing off-premise signs. In the case where the underlying zone's sign regulations differ from those of the Overlay Zone, the more restrictive shall apply.

Signs within the Overlay Zone boundaries shall comply with the General Sign Regulations (Section 40.E.) of the Zoning Code with the following provisions and exceptions:

1. No off-premise signs are allowed.
2. On-premise signs shall meet the following standards:
 - a. Location:
 1. Signs shall be limited to wall signs and free-standing signs.
 - b. Number:
 1. One wall sign shall be permitted per facade per business.
 2. One free-standing sign shall be permitted per street frontage per premises, except on premises larger than 12 acres a second free-standing sign is permitted on any given street frontage greater than 1,500 linear feet.
 - c. Size:
 1. The size of wall signs shall not exceed the following:

<u>For facade area of:</u>	<u>Allowable sign size:</u>
under 2,500 sq.ft.	12% of the facade area to which they are applied
2,500-5,000 sq.ft.	300 sq.ft.
5,001-7,500 sq.ft.	350 sq.ft.
7,501-10,000 sq.ft.	400 sq.ft.
10,001 sq.ft. and up	450 sq.ft.
 2. The size of a free-standing sign shall not exceed 75 square feet.
 - d. Height:
 1. Height of a wall sign shall not exceed the height of the wall to which it is attached.
 2. Height of a free-standing sign shall not exceed 12 feet.
3. Signs that are portable, fixed on a movable stand, self-supporting without being firmly embedded in the ground, supported by other objects, mounted on wheels or movable vehicles, or made easily movable in any manner are not permitted.
4. Signs located on rocks, trees or other natural features are not permitted.
5. Signs located on cooling towers, storage tanks, water towers, smokestacks, chimneys, or similar structures are not permitted.
6. No illuminated sign or any illuminated element of a sign may turn on and off or change in brightness. No sign or any part of a sign may move or rotate.

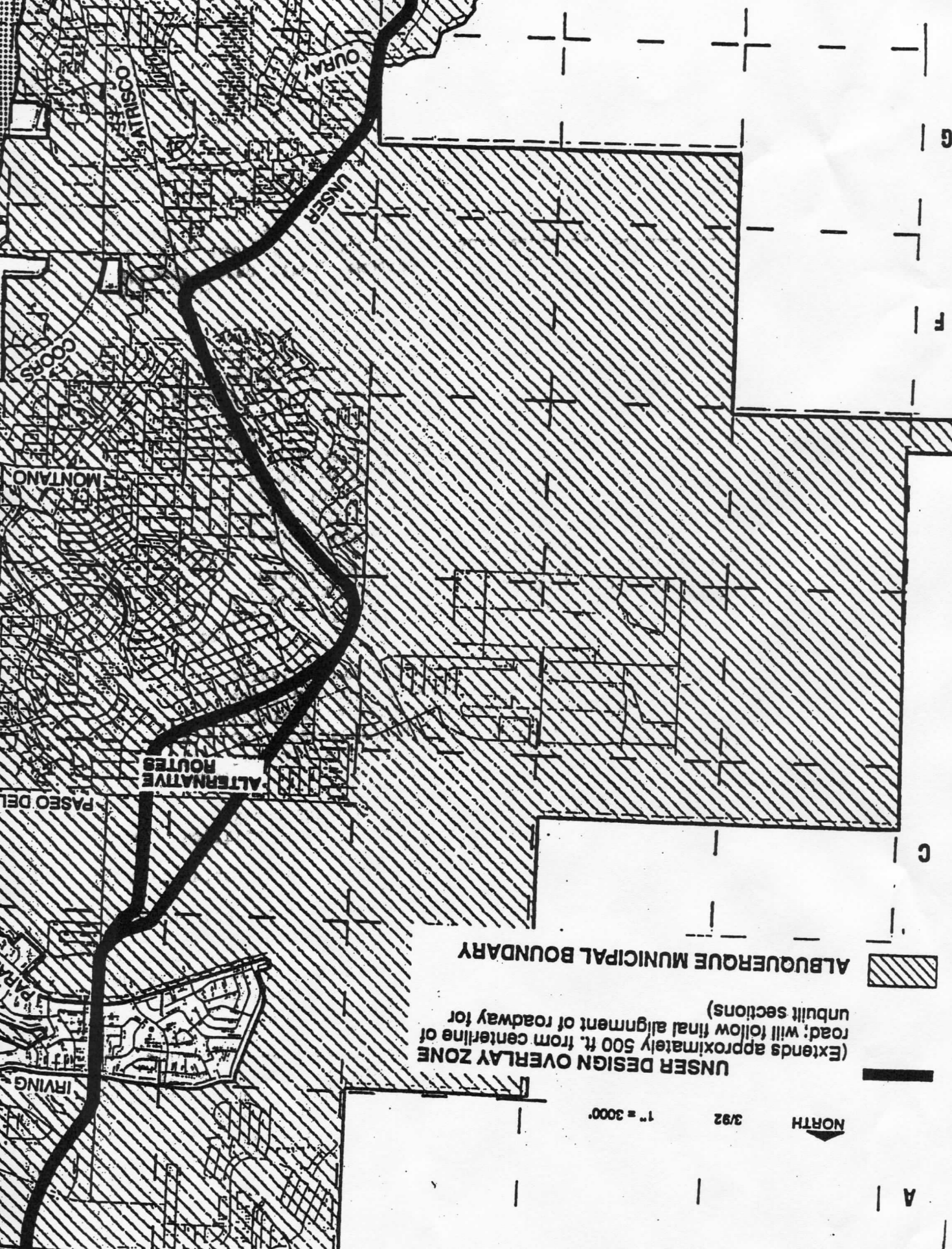

UNSEB DESIGN OVERLAY ZONE
(Extends approximately 500 ft. from centerline of road; will follow final alignment of roadway for unbuilt sections)



ALBUQUERQUE MUNICIPAL BOUNDARY



NORTH

3/92

1" = 3000'