

Lazy Day Park

An additional walking path in the southeast corner of the park connects to the Dennis Chavez Blvd. trails, where you can add more steps to your walk.

- Trail Distance:** .5 mile
- Difficulty:** Grade 1
- Steps:** 1050
- Trail Surface:** 4 foot wide concrete

Attractions: playground for young children, grassy area for frisbee, soccer, or football, covered picnic area

NEARBY MAJOR CROSS STREETS:
98th & Dennis Chavez SW

ABQ RIDE:
none

PUBLIC FACILITIES:
none

PARKING:
on street, west side of the park

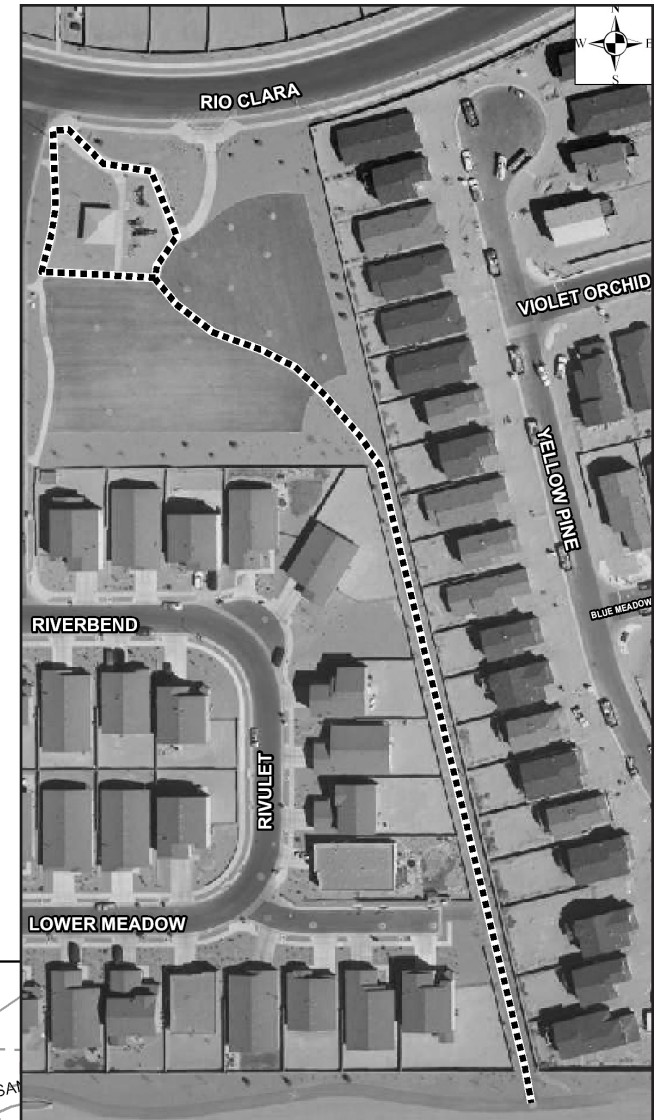

- ▲ Bus Stops
- Commuter/Peak Hour
- Local/All-Day

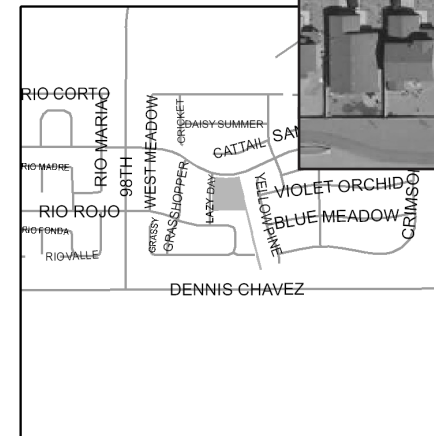

— Lazy Day Park

ZIP CODE
87121