

Advanced Map Viewer 3.0

Functionality Overview

City of Albuquerque Advanced Map Viewer 3.0

Getting Around

Maps and Data Sources

Tasks

Address Search

Clear Address Markup

Identify

Pan

Zoom In

Zoom Out

Initial View

Previous Extent

Next Extent

Full Extent

Print

Export

Global Search

Search...

Tool Labels

Layer Themes

Layers

All Available Layers

Filter Layers...

Filter

Parcels

Addresses

Streets

Planning Layers

Boundaries

Infrastructure

Historic Sites

Public Facilities

Albuquerque Public Schools

Transit

Bikeways and Trails

I want to menu

I want to menu: An easy to access menu of tools that are used most frequently.

Address Search

Search for a location by address

Clear Address Markup

View the home panel

View information about this application.

Find data on the map

Click, tap, or draw a rectangle on the map to identify features.

Change visible map layers

Alter visibility of map layers, perform layer actions, and view the legend.

Return to initial map extent

Return to the initial map position and zoom level.

Create a printable map

Create a printable map

Tool Bar

Lat: 35.12214° N

Lon: 106.64148° W

Find data on the map

Draw a Point

Plot a Coordinate

Add Some Text

Center the Map Here

Map

Map: This is where layers will display. Right clicking on the map will display another menu of commonly used tools. In addition to the tools on the toolbar, using the mouse scroll will zoom in/out and holding down the left mouse button will enable panning through the map.

Layer List

Home

Layers

Layer List

Lat: 35.15416° N

Lon: 106.38624° W

Scale 1: 144,448

Go

0 1 2mi

Planning Department, City of Albuquerque | City of Albuquerque, Planning Department, AGIS Di...

Advanced Map Viewer 3.0

Filter Layers: Enter in layer names here to find a specific layer. For example, type in HydroTrans in the box and it will filter down the layer list to that specific layer. The “x” next to the box will remove the filter.

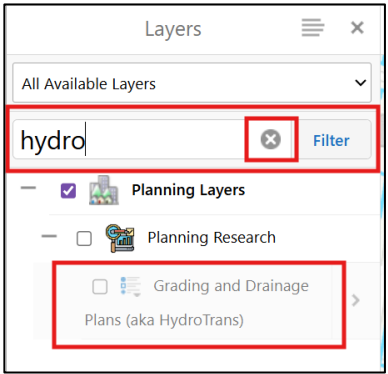

Layer Themes: This groups certain layers into themes and only shows those layers in the layer list with custom visibility settings. For example, choose public facilities to see items like parks, bikeways and trails, and centers.

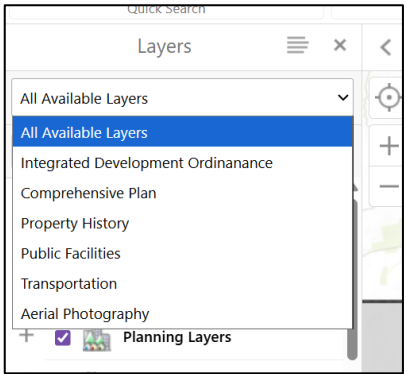

Layer List: This contains the available layers in this viewer. These are organized into folders that can be expanded using the plus sign next to the box. The box next to the folder(s) and the layer need to be checked for them to display. Some layers display with different symbols/colors (e.g., IDO Zoning). The legend can be expanded by clicking on the legend symbol next to the layer name. Layer names that appear in grey indicate that they are scale dependent and will only display when zoomed in.

Tool Bar: There are three tabs with different tool sets. Unchecking the box next to “Tool Labels” will turn the labels off and clicking on the “x” to the right will hide the entire tool bar.

Functionality Overview

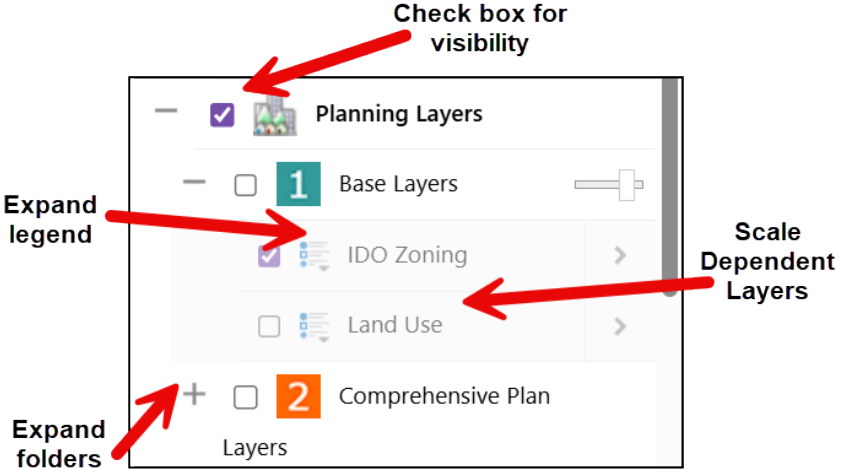

Global Search: This allows searching the entire application for a certain address, street, UPC, project number, or other keywords.

