

ABQ BIOPARK BOTANIC GARDEN

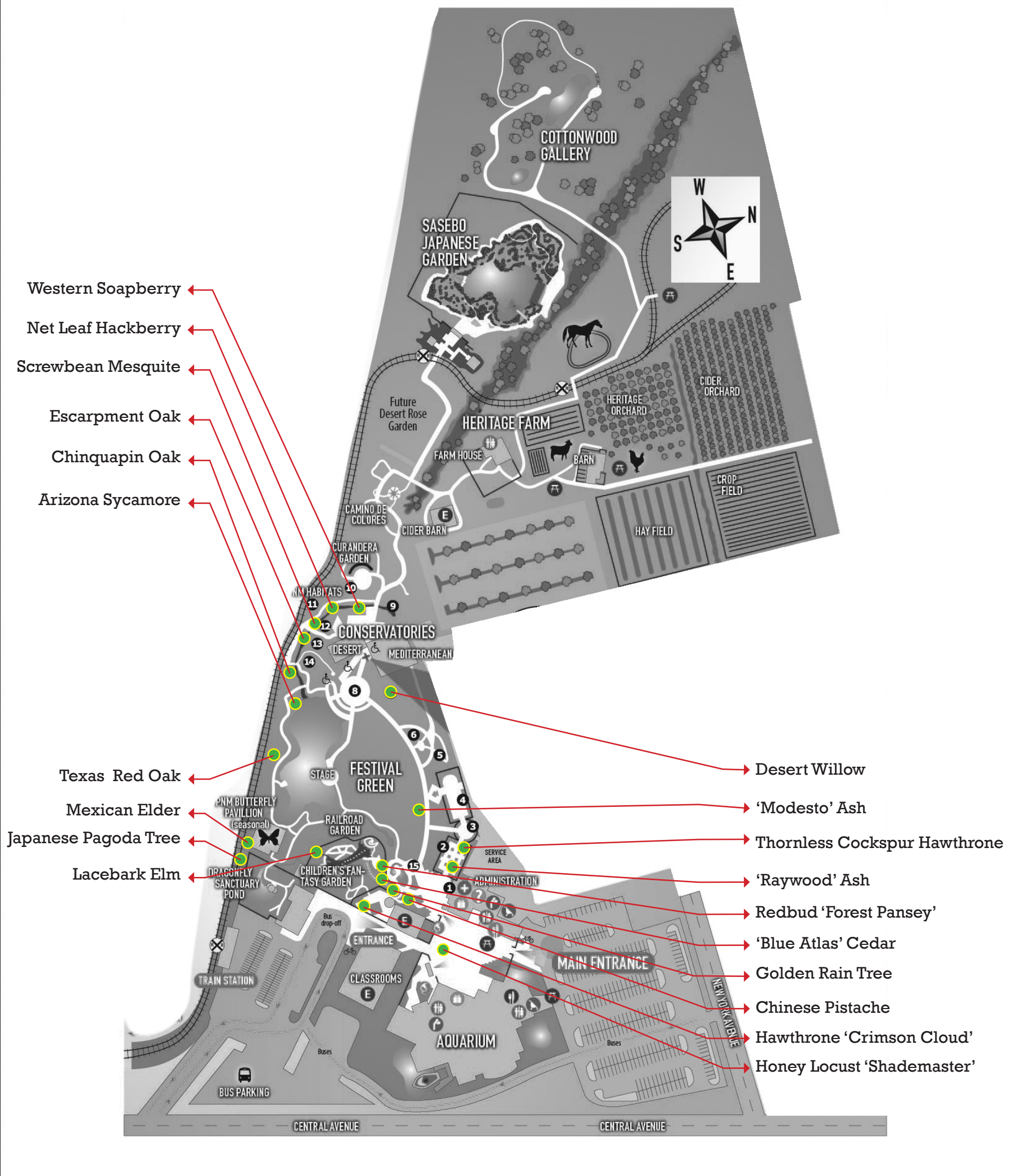

Tree Tour: Trees for Albuquerque residential landscapes

- **Arizona Sycamore** - *Platanus wrightii*
- **Blue Atlas Cedar** - *Cedrus atlantica 'Glauca'*
- **Chinese Pistache** - *Pistacia chinensis*
- **Chinquapin Oak** - *Quercus muehlenbergii*
- **Desert Willow** - *Chilopsis linearis*
- **Escarpment Live Oak** - *Quercus fusiformis*
- **Texas Red Oak** - *Quercus buckleyi*
- **English Hawthorne 'Crimson Cloud'** - *Crataegus laevigata 'Crimson Cloud'*
- **Goldenrain Tree** - *Koelreuteria paniculata*
- **Honeylocust 'Shademaster'** - *Gleditsia triacanthos 'Shademaster'*
- **Japanese Pagoda Tree** - *Styphnolobium japonicum*
- **Lacebark Elm** - *Ulmus parvifolia*
- **Mexican Elder** - *Sambucus mexicana*
- **Net-Leaf Hackberry** - *Celtis reticulata Torr.*
- **Thornless cockspur Hawthorn** - *Crataegus crus-galli Inermis*
- **Modesto Ash** - *Fraxinus velutina 'Modesto'*
- **Raywood Ash** - *Fraxinus angustifolia 'Raywood'*
- **Redbud 'Forest Pansey'** - *Cercis Canadensis 'Forest Pansey'*
- **Sqrewbean Mesquite** - *Prosopis pubescens*
- **Western Soapberry** - *Sapindus drummondii*