

Bataan Park

Trail Distance: .33 mile

Difficulty: Grade 2

Steps: 700

Trail Surface: 4-6 foot wide concrete and packed gravel

Attractions: picnic tables, large shade trees, lots of activity and good visibility

NEARBY MAJOR CROSS STREETS:

Lomas & Carlisle
NE

ABQ RIDE:
#5, #11

**PUBLIC
FACILITIES:**
Drugstore, other
shops
nearby

PARKING:

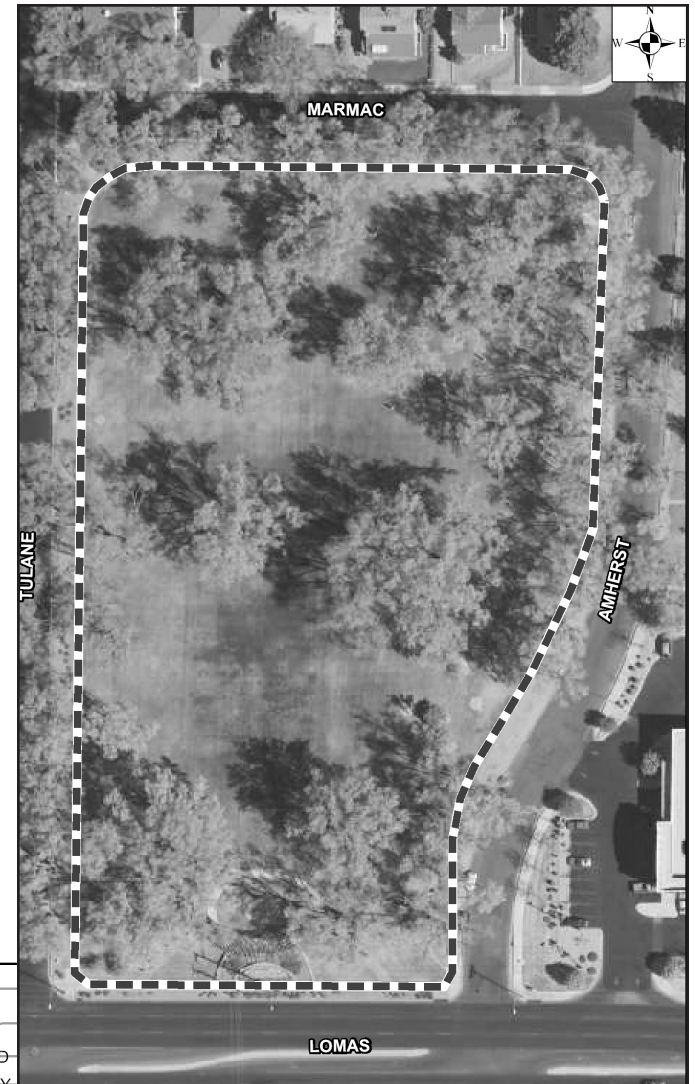

- ▲ Bus Stops
- Commuter/Peak Hour
- Local/All-Day

