

Family Art from Home

Kinetic Face

by Yana Apostalon



Kinetic art depends on motion for its effects. In this project, create a kinetic sculpture animating the facial features of either yourself or a family member. This project has many steps so you can easily assign different parts of the project to others and make it a true family project!

Supplies Needed

- Cardboard
- 2 Skewers
- Paper
- Markers
- Tacky glue
- Pencil
- X-acto knife or scissors
- Ruler
- Extra cardboard to cut on
- Newspaper to paint on
- White paint
- Optional: Thin wire

How to Do It

MAKING THE CUBE

1. Measure out a strip of cardboard that is 3×9 inches. Make marks at the 3 and 6 inch measurements on top and bottom of the cardboard piece. (See # 1)

2. Cut parallel lines into the cardboard with the X-acto knife, or a single blade of the scissors, making sure to only cut through the top layer of cardboard, so it can be folded (See #2). You can now paint the cardboard white with acrylic paint, or whatever color you'd like. This step is optional.

3. Cut out two cardboard oval pieces of the same shape no wider than 2 inches (See #3). Use the X-acto knife to "drill" holes slightly off center in the ovals. Cut out two cardboard circles which are

#1

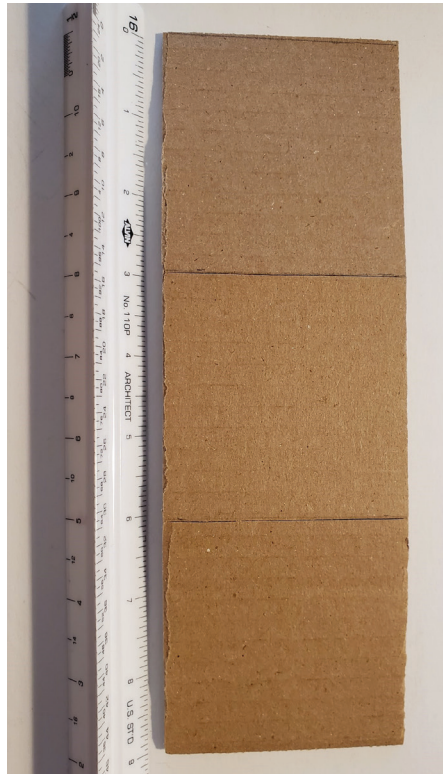

#2

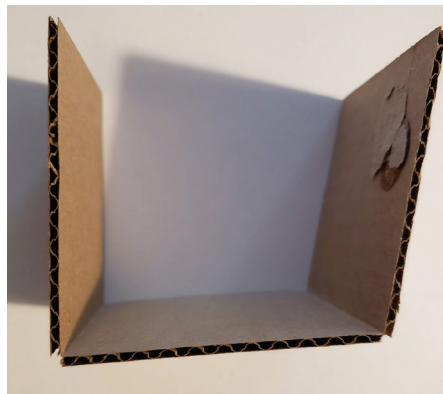

#3



Albuquerque Museum
2000 Mountain Road NW
Albuquerque, NM 87104
505-243-7255 • cabq.gov/museum



approximately 1 inch in diameter. Cut one larger circle which is approximately 1.5 inches in diameter, drill a hole in the middle. Cut 7 smaller circles approximately half an inch in diameter. These sizes can be adjusted later, if need be. Optional: Paint all the circles white.

4. Take the paper, cut a square approximately 2x2 inches. Wrap this paper around a skewer, loose enough for the skewer to slide through the paper straw. Apply glue to the edge and smooth it over to create a straw. Cut the paper straw in two equal pieces.

#4

5. Once the 3x9 cardboard piece is dry, drill a skewer sized hole in the center of the two outer panels. Drill a hole through only one layer of all the 1/2 inch circles and two of the 1 inch circles as well. Thread a skewer through one of the outside panels. Thread on the two ovals. Position them so they make an "X". Thread the skewer through the second outside panel. (See #4)

6. Drill two holes with the X-acto knife in the top panel through the centerline, above the skewer, more than an inch apart. Place the paper straws you made in the holes, so they are snug, secure with glue if need be. Glue the ovals into place below the two holes you just made, keeping them perpendicular to each other (in an "x" if you look from the side). (See #4)

7. Place two skewers about 5 inches long into the paper straws. The skewers should come close to resting on the ovals below. Attach the 1 inch circles to the bottom of the skewers so there is a barrier between the ovals and the skewer ends. (See #4)

8. Add two supporting skewers to the bottom of the open cube, secured by 4 of the 1/2 circles. One on each side of the skewers. Next take the 1.5 inch circle and place it on the other end of the skewer running through both of the outside panels. Cut the skewer long enough so that two layers of cardboard can be glued on. Glue one of the 1/2 inch circles to the end of the skewer to create a cap, so it is securely attached. (See #4)

9. Make the crank handle by gluing a 2 inch section of skewer to the last 1/2 in. circle, place it as close to the outer edge of the larger circle as possible. The circle should be able to move in either direction. If the ovals do not have smooth edges, this will be a little cumbersome. (See #5)

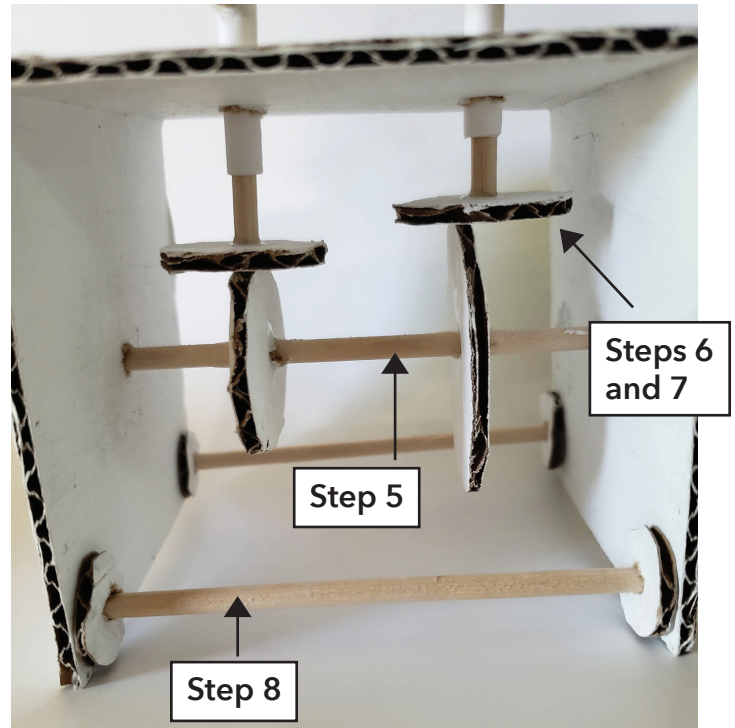

#5



MAKE YOUR FACE!

11. Cut out two cardboard eye shapes and paint them white. If you would like the eyes to move, cut out two slits in the cardboard. If not, draw on irises after the paint is dry.

12. To make eye lashes, cut two strips of paper that are as long as the top of your eye shape, make a fringe using the X-acto knife. Curl the paper by wrapping it around a skewer. Glue to the top of the eye shapes. Use the same technique for the eyebrows. You can use markers to color the eyelashes and eyebrows.

13. Glue the eye shapes to the section of paper straw that sticks out of the top of your cardboard base. If you want the eyes to move, cut out two circles and draw on the pupils and iris. Glue them to a thin malleable piece of wire. Thread the wire through the slit in the cardboard eyes and wrap it tightly around the skewer.

Now you have a moving sculpture! Have fun with it and see what other pieces you could make with the moving parts. Stay healthy and enjoy :)

